

Accutest® iFOBT Dual-Sample Fecal Occult Blood Test PROCEDURE CARD

**READ PROCEDURE CARD BEFORE RUNNING TEST.
REFER TO PACKAGE INSERT FOR DETAILS.**

- 1) SHAKE THE SAMPLE COLLECTION TUBE VIGOROUSLY TO ENSURE A GOOD LIQUID SUSPENSION.

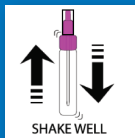

- 2) HOLDING THE TUBE UPRIGHT, UNSCREW THE CLEAR TIP COVER.

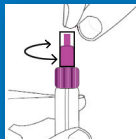

- 3) DISPENSE FOUR (4) DROPS OF SUSPENSION FROM EACH TUBE INTO APPROPRIATE SAMPLE WELL:

A) FOUR (4) DROPS FROM SAMPLE COLLECTION TUBE ONE (1) SHOULD BE PLACED INTO SAMPLE WELL ONE (S1).



B) FOUR (4) DROPS FROM SAMPLE COLLECTION TUBE TWO (2) SHOULD BE PLACED INTO SAMPLE WELL TWO (S2).

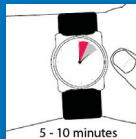

- 4) READ RESULTS WITHIN 5-10 MINUTES AFTER ADDING THE EXTRACTION SOLUTION.

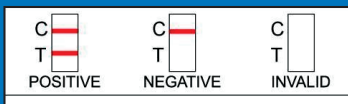

**Note: Do not interpret the results after more than 10 minutes.
Discard the test device after reading and recording the results.**