



PATIENT INSTRUCTIONS

This easy-to-use test can assist your physician in identifying blood in your stool. Occasionally, blood is present but not easy to see. Many types of health conditions can lead to blood in your stool. They include hemorrhoids, precancerous colonic growths, colorectal cancer as well as peptic ulcer.

PRIOR TO COLLECTING THE SAMPLE

1. It is not necessary to eliminate any foods from your diet.
2. Bleeding hemorrhoids can interfere with test results. If you have hemorrhoids, collect the stool sample only when the bleeding stops. Menstrual bleeding also interferes with test results. Collect sample when this will not be an issue.
3. Alcohol and certain medications such as aspirin, indomethacin, reserpine, phenylbutazone, corticosteroids and non-steroidal anti-inflammatory drugs (e.g. Ibuprofen) may cause gastrointestinal irritation and subsequent bleeding in some patients. Such substances should be discontinued at least 48 hours prior to testing.

SAMPLE COLLECTION PROCEDURE

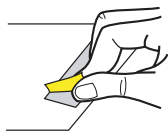

1. Peel off tape covering adhesive strips - located on each end of sample collection paper.



2. Lift toilet seat and place sample collection paper across rim of toilet bowl. Use adhesive strips, located on each side of sample collection paper, to secure it to sides of toilet rim, as shown.



3. Replace toilet seat onto toilet bowl.



4. Deposit bowel movement (stool) onto sample collection paper.



5. Carefully review instructions and illustrations on how to collect stool sample. **Collect samples as described in steps 5A-5E below.**
Note: Do not use stool sample as test specimen if it comes in contact with toilet water.

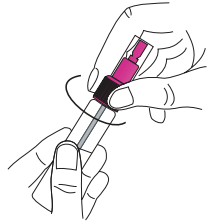

5A. Unscrew the purple cap of the sample collection tube and remove the applicator stick. Use Sample Collection Tube 1 for Day 1 and Sample Collection Tube 2 for Day 2.

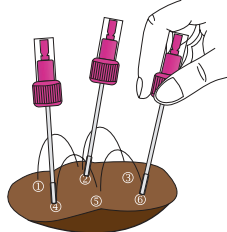

5B. Insert the applicator stick into the stool sample at 6 different sites.

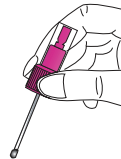

5C. Use only enough stool to cover the tip of the applicator stick.

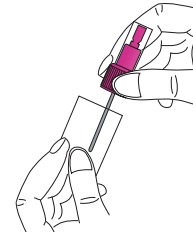

5D. Remove the excess sample from the stick by gently wiping with absorbent tissue.

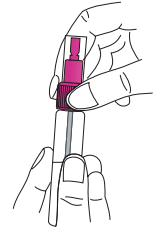

5E. Replace the applicator stick in the tube and tighten securely.

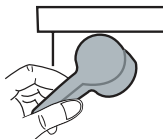

6. After collecting stool sample, flush stool and sample collection paper down toilet.

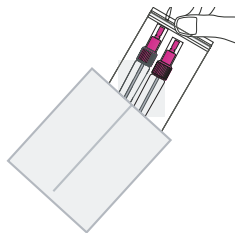

7. Set aside sample from Day 1. Repeat sample collection procedure on the following day (Day 2).

8. Complete information requested on patient return form and collection tubes from Day 1 and 2. Place tubes into reclosable bag and enclose with form into supplied plastic mailing envelope. Seal plastic mailing envelope.



9. Write your clinic or physician address on plastic mailing label.



10. Return the sealed plastic mailing envelope as soon as possible to your physician, clinic or laboratory by mail or in person.

Return collection tubes with sample as soon as possible. They should be stored at room temperature (36-98.6°F) prior to returning to physician or clinic.

JANT PHARMACAL CORPORATION

16255 Ventura Blvd., #505, Encino, CA 91436 800.676.5565 818.986.8530 Fax 818.986.0235 www.accutest.net info@accutest.net
Accutest is a registered trademark of Jant Pharmacal Corporation